

Vorpa IF-IF0

Isophonic pipe clamp for iron and Polyethylene pipes



Concrete



Natural stone



Solid brick

Products group



pipe clamp if with rubber and plastic plug



pipe clamp IF0 with rubber

Suitable for

- Concrete
- Natural stone
- Solid brick

To fix

- Industrial plants
- High temperature exhaust fumes
- High temperature liquid discharge

Examples of applications

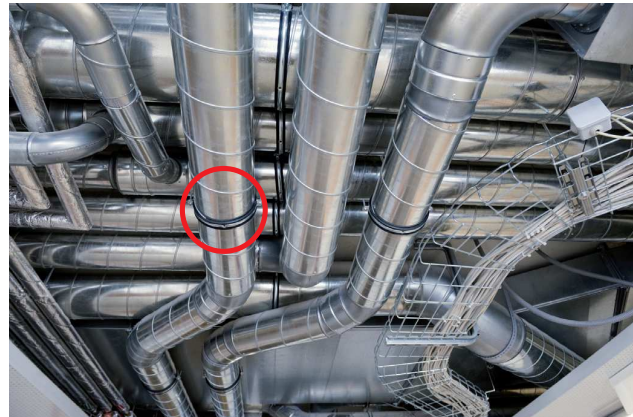

Installation sequence

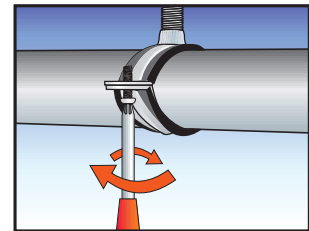
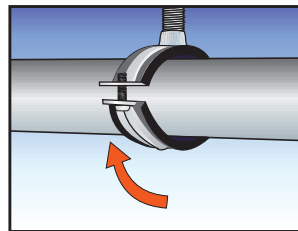
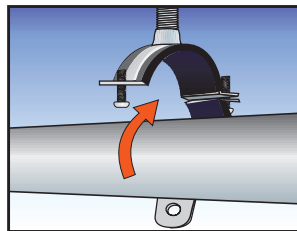
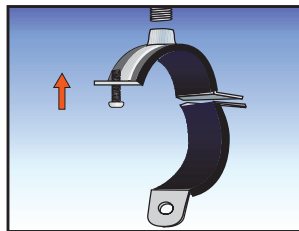

Product information

Characteristics

- Isophonic pipe clamps with rubber and wall plastic plug

Benefits

- Two screws allows for easy adjustment to suit the outer pipe diameter
- Combination nut with thread M8/M10
- The sound insulation rubber offers noise protection and avoids contact corrosion
- Screws safety feature
- Wall nylon plug VN with anti-rotation wings

Suggestion for use

- Always check load bearing capacity values in the table
- Respect the installation data
- Clean the hole before the installation

Vorpa IF-IFO

Isophonic PIPE CLAMP for iron and Polyethylene pipes



Technical data



pipe clamp if with rubber and plastic plug



pipe clamp IFO with rubber

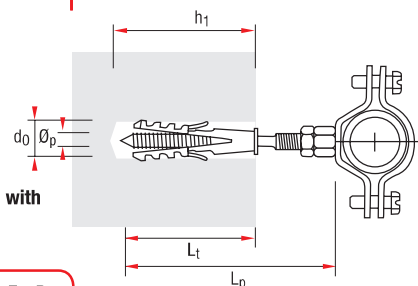

- d_0 = Hole diameter
- h_1 = Min. hole depth
- L_t = Anchor length
- L_p = Pin length
- ExD = Width x thickness
- \emptyset = Pipes
- \emptyset_p = Pin diameter

Code	Description	L_t mm	d_0 mm	h_1 mm	$\emptyset_p \times L_p$ mm	side screws	\emptyset	E x D
4699	IF 12-15	60	10	80	M8x90	M6x20	1/4	20x2
4700	IF 15-19	60	10	80	M8x90	M6x20	3/8	20x2
4701	IF 20-25	60	10	80	M8x90	M6x20	1/2	20x2
4702	IF 26-30	60	10	80	M8x90	M6x20	3/4	20x2
4703	IF 32-36	60	10	80	M8x90	M6x20	1"	20x2
4704	IF 38-43	60	10	80	M8x90	M6x20	1" 1/4	20x2
4705	IF 47-51	60	10	80	M8x90	M6x20	1" 1/2	20x2
4706	IF 53-58	60	10	80	M8x90	M6x20	53-58	20x2
4707	IF 60-64	60	10	80	M8x90	M6x20	2"	20x2
4708	IF 68-72	60	10	80	M8x90	M6x20	68-72	20x2
4709	IF 76-80	60	10	80	M8x90	M6x20	2" 1/2	20x2
4710	IF 81-86	60	10	80	M8x90	M6x20	81-86	20x2
4711	IF 87-92	60	10	80	M8x90	M6x20	3"	20x2
4712	IF 99-105	60	10	80	M8x90	M6x20	3" 1/2	20x2,5
4713	IF 107-112	60	10	80	M8x90	M6x20	107-112	20x2,5
4714	IF 113-118	60	10	80	M8x90	M6x20	4"	20x2,5
4715	IF 125-130	60	10	80	M8x90	M6x20	125-130	20x2,5
4716	IF 135-140	60	10	80	M8x90	M6x20	5"	20x2,5
4717S	IF 159-166	60	10	80	M8x90	M6x20	159-166	20x2,5
4717	IF 168-172	60	10	80	M8x90	M6x20	6"	20x2,5
4718	IF 200-212	60	10	80	M8x90	M6x20	200-212	20x2,5

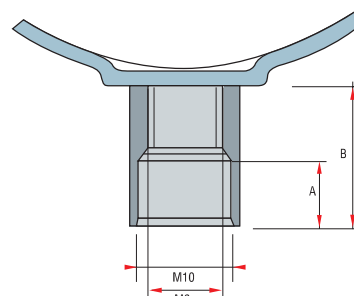
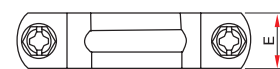
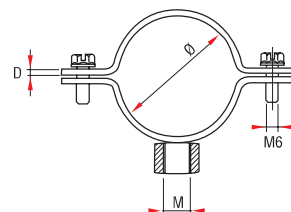

Code	Description	A mm	B mm	M thread	side screws	\emptyset	E x D
2699	IFO 12-15	9	16	M8/M10	M6x20	1/4	20x2
2700	IFO 15-19	9	16	M8/M10	M6x20	3/8	20x2
2701	IFO 20-25	9	16	M8/M10	M6x20	1/2	20x2
2702	IFO 26-30	9	16	M8/M10	M6x20	3/4	20x2
2703	IFO 32-36	9	16	M8/M10	M6x20	1"	20x2
2704	IFO 38-43	9	16	M8/M10	M6x20	1" 1/4	20x2
2705	IFO 47-51	9	16	M8/M10	M6x20	1" 1/2	20x2
2706	IFO 53-58	9	16	M8/M10	M6x20	53-58	20x2
2707	IFO 60-64	9	16	M8/M10	M6x20	2"	20x2
2708	IFO 68-72	9	16	M8/M10	M6x20	68-72	20x2
2709	IFO 76-80	9	16	M8/M10	M6x20	2" 1/2	20x2
2710	IFO 81-86	9	16	M8/M10	M6x20	81-86	20x2
2711	IFO 87-92	9	16	M8/M10	M6x20	3"	20x2
2712	IFO 99-105	9	16	M8/M10	M6x20	3" 1/2	20x2
2713	IFO 107-112	9	16	M8/M10	M6x20	107-112	20x2,5
2714	IFO 113-118	9	16	M8/M10	M6x20	4"	20x2,5
2715	IFO 125-130	9	16	M8/M10	M6x20	125-130	20x2,5
2716	IFO 135-140	9	16	M8/M10	M6x20	5"	20x2,5
2718S	IFO 159-166	9	16	M8/M10	M6x20	159-166	20x2,5
2718	IFO 168-172	9	16	M8/M10	M6x20	6"	20x2,5
2719	IFO 200-212	9	16	M8/M10	M6x20	200-212	20x2,5

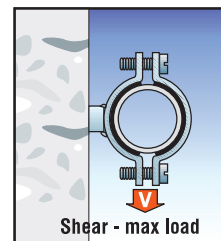

V = 70 daN

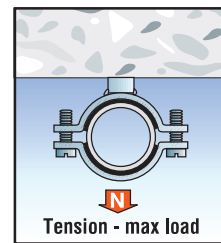

V = 100 daN

always consider an appropriate safety factor

Max load on concrete C25/30 = when the steel clamp loses its shape characteristics